

DYNAMIC POSTER STANDS

content*

Quantity

- Pole Profiles 2
- Base 1
- Racks (you need) *
- Snap Frame (you need) *

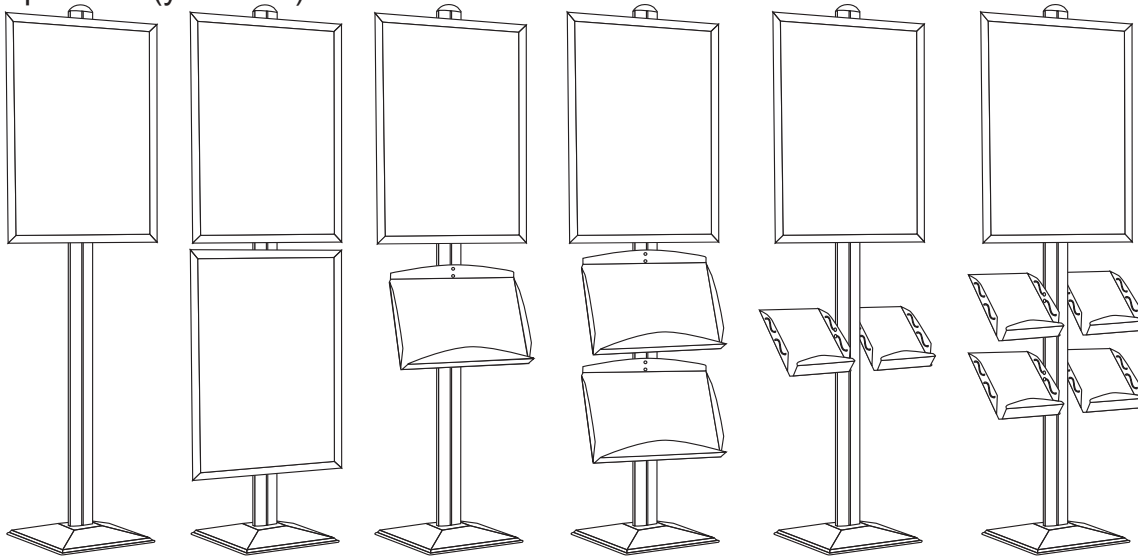

assembly instructions

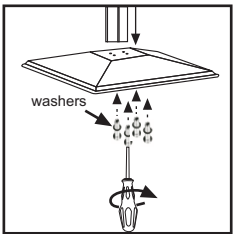

1) Fix the base to the pole

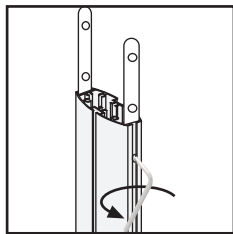

2) Screw the profile

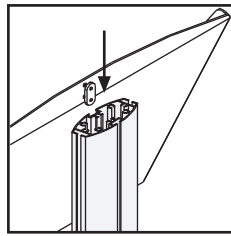

3) Slide in the connectors of racks gently to the channel of the pole

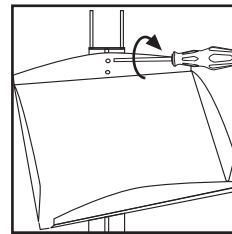

4) Screw the bolts of the racks tightly.

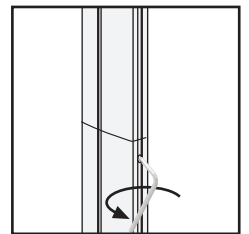

5) Screw the other pole profile to the first one tightly.

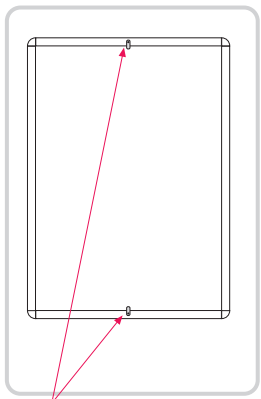

6) Slide in the back connectors of the frame in the channel of the pole profile as the racks..

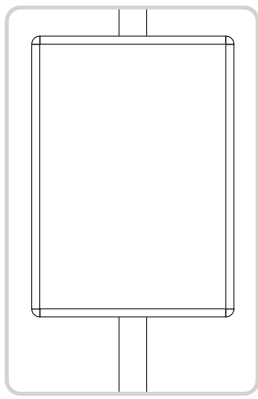

7) Open the top & bottom profiles of the frame, screw the frame in the desired position.

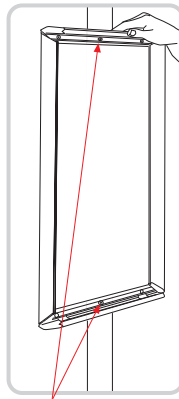

8) Put the cap on the pole profile. DONE !...

